

DRIVEWAY PERMIT APPLICATION

TO: THE UPSHUR COUNTY COMMISSIONERS COURT  
COUNTY OF UPSHUR  
GILMER, TEXAS

PRECINCT: 3

DATE: June 27, 2022

Formal notice is hereby given that Lorri Hart, whose principal address is 1561 Ironwood, does hereby purpose to place a driveway culvert within the ROW of County Road Ironwood. Proposed construction will begin, if approved, on or after the 15<sup>th</sup> day of July, 2022. I, Lorri Hart, hereby attest that I have read the conditions set forth in this application and understand its contents. The culvert will be placed by County equipment and personnel. This is a new installation.

SIGNATURE Lorri Hart  
TELEPHONE: 432-257-4205

APPROVAL OF PERMIT APPLICATION

The Upshur County Commissioners Court offers no objection to the location on the right of way of your proposed driveway culvert for the address shown above. The proposed driveway structure will be a "x" culvert.

Recommended by [Signature]

APPROVED ON THIS \_\_\_\_\_ DAY OF \_\_\_\_\_, 20\_\_.

FILED  
TERRI ROSS  
COUNTY CLERK  
2022 JUL 15 PM 2:29  
BY [Signature]  
UPSHUR COUNTY, TX.  
CLERK

**DRIVEWAY PERMIT APPLICATION**

TO: THE UPSHUR COUNTY COMMISSIONERS COURT  
COUNTY OF UPSHUR  
GILMER, TEXAS

PRECINCT: 2

DATE: June 30, 2022

Formal notice is hereby given that Courtney Cobb, whose principal address is 12551 Stinson Road, does hereby purpose to place a driveway culvert within the ROW of County Road Stinson.

Proposed construction will begin, if approved, on or after the 15<sup>th</sup> day of July, 2022. I, Courtney Cobb, hereby attest that I have read the conditions set forth in this application and understand its contents. The culvert will be placed by County equipment and personnel. This is a new installation.

SIGNATURE:   
TELEPHONE: 903-576-0959

**APPROVAL OF PERMIT APPLICATION**

The Upshur County Commissioners Court offers no objection to the location on the right of way of your proposed driveway culvert for the address shown above. The proposed driveway structure will be a "x" culvert.

Recommended by 

APPROVED ON THIS \_\_\_\_\_ DAY OF \_\_\_\_\_, 20\_\_.

APPROVAL

TO: Hayes Engineering Inc.  
3670 SH 155 S  
Gilmer, TX 75645

DATE July 17, 2022

The Upshur County Commissioners Court offers no objections to the location on the right-of-way of your proposed installation of a 6" PVC Water Main on the north side and within the R.O.W. of Bluebird Road, from US Highway 271, 7445 feet to the east end of proposed water main will be 805 feet west of S.H. 300, as shown by accompanying drawings and notice dated 12/2/19, except as noted below:

N/A

It is expressly understood that the Upshur County Commissioners Court does not purport, hereby, to grant and right, claim, title, or easement in or upon this county road; and it is further understood that in the future should for any reason Upshur County need to work, improve, relocate, widen, increase add to or any manner change the structure of this right-of-way line, this line, if affected, will be moved under the direction of the Road Administrator and shall be relocated at the complete expense of the owner. Upshur County shall be notified a minimum of 48 hours prior to the beginning of any work.

All work on the county right-of-way shall be performed in accordance with the Road Administrator's instructions. The installation shall not damage any part of the highway and adequate provisions must be made to cause minimum inconvenience to traffic and adjacent property owners. Special specifications for placing this line are as follows:

1. All ground lines are to be installed a minimum of 36 inches below the flowline of the adjacent drainage or borrow ditch.
2. All excavations within the right-of-way and not under surfacing shall be backfilled by tamping in 6 inch horizontal layers. All surplus material shall be removed from the right-of-way and the excavation finished flush with surrounding natural ground.
3. Lines crossing under surfaced roads and under surfaced cross roads within the right-of-way shall be placed by boring. Boring shall extend from crown line to crown line.
4. All lines under roads carrying pressure in excess of 50 psi shall be enclosed in satisfactory casing extending from right-of-way line to right-of-way line. Pipe used for casing may be of any type approved by the Road Administrator and shall be capable of Supporting the load of roadbed and traffic and shall be so constructed that there will be no leakage of any matter through the casing for its entire length. Inside diameter of casing shall be at least 2 inches greater than the largest outside diameter of carrier pipe, joint or couplings. (Encasement is not required on lines installed 48 inches or greater below flowline.)
5. All lines, where practicable, shall be located to cross roadbed at approximately right angles thereto. No lines are to be installed under or within 50 feet of either end of a bridge unless approved by the Road Administrator in writing. No lines shall be placed inside any culvert or within 10 feet of the closest point of same.
6. Parallel lines will be installed as near the right-of-way lines as is possible and no parallel line will be installed in the roadbed or between the drainage ditch and roadbed unless approved by the Road Administrator in writing.
7. Overhead lines will have a minimum clearance of 18 feet above the road surface at point of crossing.
8. Operations along roadways shall be performed in such a manner that all excavated material be kept off the pavements at all times, as well as all operating equipment and materials. Do not use equipment or installation procedures which will damage any road surface or structure. The cost of any repairs to road surfaces, roadbed, structures or other right-of-way features as direct result of this installation will be borne by the owner of this line.
9. Barricades, warning signs, lights and flagmen, when necessary, shall be provided by the contractor or owner. One half of the traveled portion of the road must be open to traffic at all times. All traffic control shall be in accordance with the requirements of the current version of the Texas MUTCD.
10. Utility company shall install adequate erosion control measures for any excavation work being performed.

Revised 11/30/10



NOTICE OF PROPOSED INSTALLATION  
PIPE AND/OR UTILITY LINES

TO: UPSHUR COUNTY COMMISSIONERS COURT  
c/o UPSHUR COUNTY ENGINEER  
UPSHUR COUNTY ROAD & BRIDGE DEPARTMENT  
P. O. BOX 730  
Gilmer, TX 75644

DATE: July 11, 2022

EXPIRES: \_\_\_\_\_

Formal notice is hereby given that \_\_\_\_\_ proposes to bore a \_\_\_\_\_ line within the right-of-way of County Road \_\_\_\_\_ as follows:

PRITCHETT W.S.C. PROPOSES TO INSTALL A 6" Pvc WATER MAIN ON THE NORTH SIDE AND WITHIN THE R.O.W. OF BLUEBIRD ROAD, FROM U.S. HWY. 271, 7445 FEET TO THE EAST. END OF PROPOSED WATER MAIN WILL BE 805 FEET WEST OF S.H. 300.

THE PROPOSED 6" WATER MAIN CROSSING OF BOB O'LINK ROAD WILL BE BORED AND ENCASED IN 10" STEEL PIPE.

The location and description of the proposed line and appurtenances is more fully shown by three copies of drawings attached to this notice. The line will be constructed and maintained on the County right-of-way as directed by the County Engineer in accordance with current Upshur County specifications.

Construction of this line will begin on or after the 15 day of AUG, 20 22 and will be completed within 90 days of the date of approval.

Firm \_\_\_\_\_ HAYES ENGINEERING INC.  
By \_\_\_\_\_ RUSS CRAWFORD  
Title \_\_\_\_\_ ENGINEERING TECHNICIAN  
Address \_\_\_\_\_ 2126 ALPINE ST., LONGVIEW, TX.  
75601

- NOTE: 1. This form to be submitted in triplicate for each proposed installation.  
2. The permit shall be in effect until the utility line is removed from the right of way.  
3. Inform the County Engineer if work is not completed within this time.

# PRITCHETT WATER SUPPLY CORPORATION

WATER SYSTEM IMPROVEMENTS

## BLUEBIRD ROAD - 6" WATER MAIN

(BETWEEN U.S. 271 AND S.H. 300)

UPSHUR COUNTY, TEXAS

APPROVED BY:

PRITCHETT WATER SUPPLY CORPORATION

 6-27-21  
CHARLES MEADOR DATE  
MANAGER

PRITCHETT WATER SUPPLY CORPORATION

HENRY (BUBBA) CASEY - PRESIDENT  
BENJI GAMBELL - VICE PRESIDENT  
JOSH MARRS - SECRETARY/TREASURER  
RUSSELL WASHBURN  
DANNY WEEMS  
GEOERGE STEVENSON  
JAMES MCCRAW, JR.  
RANDALL SWITZER  
DAVID YORDY

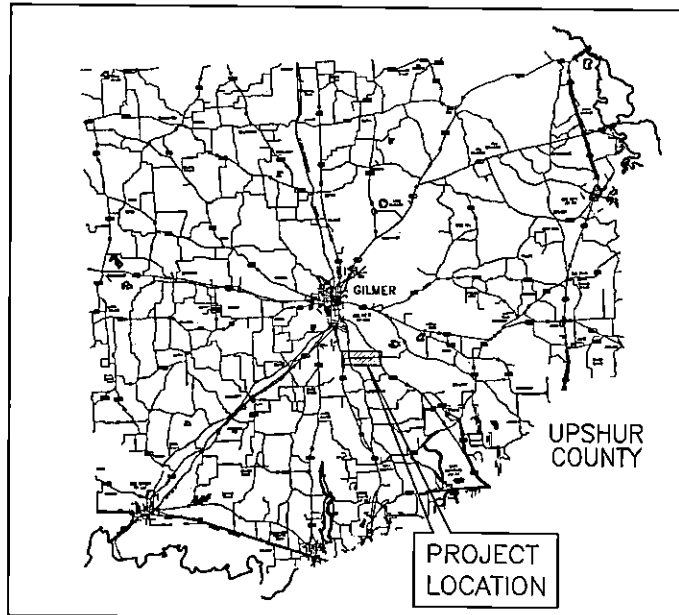

VICINITY MAP  
N.T.S.

SUBMITTED BY:



**HAYES ENGINEERING, INC.**

Texas Registered Engineering Firm F-1465  
2128 Alpine St., Longview, TX 75601-3401  
PH. (903) 756-2010, FAX. (903) 756-2099

  
AUSTIN C. LIGHTLE, P.E.  
PROJECT MANAGER

DATE

### TABLE OF CONTENTS

SHEET NO.	DESCRIPTION
1	TITLE SHEET
2	GENERAL NOTES & LOCATION MAP
3	PROPOSED 6" WATER MAIN - BLUEBIRD ROAD
4	PROPOSED 6" WATER MAIN - BLUEBIRD ROAD
5	PROPOSED 6" WATER MAIN - BLUEBIRD ROAD
6	MISCELLANEOUS DETAILS 1
7	MISCELLANEOUS DETAILS 2



PR-21-01  
SHEET 1 OF 7

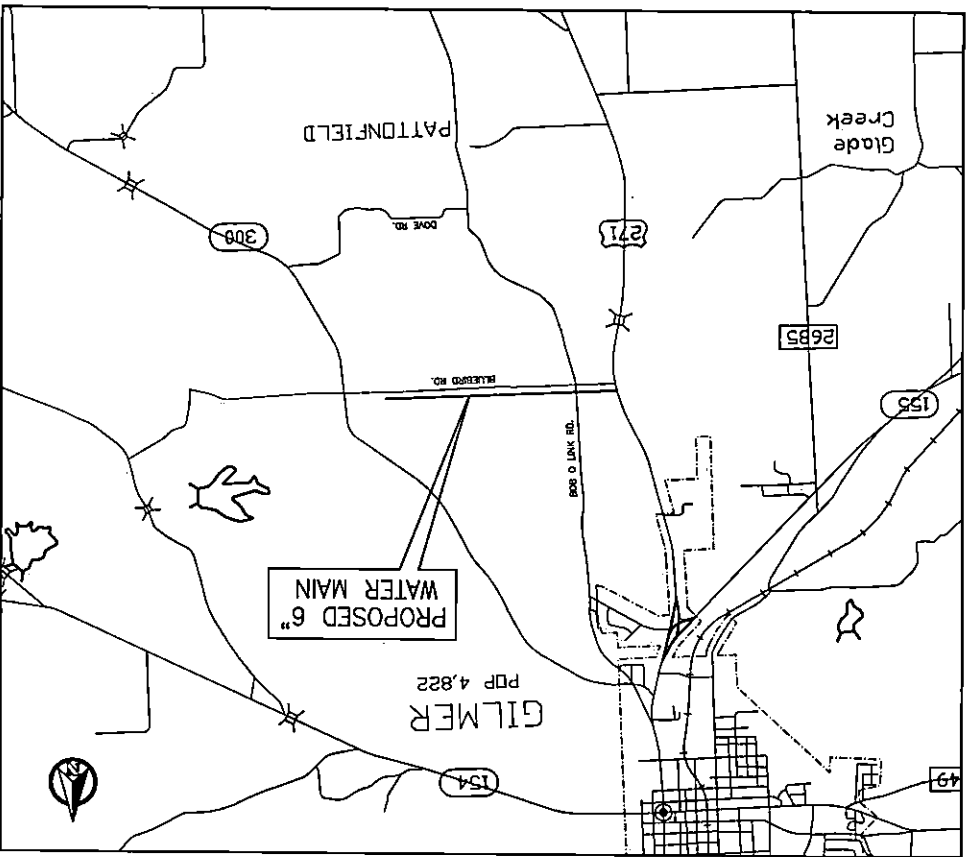

LOCATION MAP  
N.T.S.

- GENERAL CONSTRUCTION NOTES**
- (1) All existing structures damaged by construction shall be repaired or replaced to existing or better condition unless otherwise noted.
  - (2) All signs, markers, reflectors, etc. affected by construction shall be replaced to original or appropriate location.
  - (3) All work performed within State Highway ROW shall be subject to all TxDOT regulations. (Workplaces, signing, safety, traffic control, etc.)
  - (4) All work at motorist shall be subject to the Engineer's approval during construction and upon completion.
  - (5) Unless otherwise indicated on the plans, all water mains shall be installed with a minimum of 36" of cover between top of pipe at location of adjacent ditch line.
  - (6) Stockpiling of materials on private property will not be allowed without written permission from the property owner.
  - (7) All utility service lines broken or interrupted by the contractor's operation shall be repaired immediately.
  - (8) Contractor to notify TxDOT 48 hours prior to construction in State Hwy. ROW.
  - (9) Contractor shall be responsible for notifying property owners prior to entry to property. Temporary fencing shall be installed at fence crossings immediately. Permitting fencing shall be completed upon completion of clean-up.
  - (10) Contractor shall have utilities located and shall be responsible for damage to all utilities arising from contractor's work regardless of being shown or omitted from these drawings.
  - (11) All driveways shall be restored to existing or better conditions.
  - (12) All ditches shall be deepened or as directed by Engineer.
  - (13) Pipe material and class not specifically indicated on the drawings shall be indicated in the specifications.
  - (14) All existing curbs removed or damaged due to construction are to be re-laid to grade or replaced to original or better condition. All ditches affected by construction are to be graded for appropriate drainage.
  - (15) Contractor shall furnish a final vertical bands or defect proposed pipe as required for vertical deflections not specifically noted in the plans.
  - (16) Pipe deflection not to exceed manufacturer's recommended maximum deflection per pipe joint.
  - (17) Contractor to verify location, size, & fittings of existing water mains to be tied into. If not as shown, notify Engineer for approval of changes.
  - (18) Contractor shall remove and replace all existing foundations including but not limited to sprinkler systems, driveway, sidewalk, and any other ground cover to existing or better conditions with identical or similar materials as directed by the Engineer.
  - (19) All R.O.W. and easements shall be cleared & grubbed five feet on each side of the water main as installed.
  - (20) The contractor shall be responsible for taking necessary precautions to see that erosion is controlled and equipment is protected as to protect the quality. Performance of Notices General Permits for Storm Water Discharges from Construction Activities in Region 6; Notice.
  - (21) The contractor shall keep clean-up daily with construction. The contractor shall keep ditches clean of construction debris and tree trimmings.
  - (22) "Mega-Lug", or equal mechanical joint materials shall be used for all fittings and valves upon completion.
  - (23) All work within County R.O.W. shall be subject to county representatives approval.
  - (24) Estimated quantities for borse, borse with encasement, open-cuts with encasement, & directional boxes shall include center pipe.



DATE OF P.L.C. 08/21/2010  
 DRAWN BY: A.C.L.  
 CHECKED BY: A.C.L.  
 DATE: 08/21/2010  
 AS NO. 1: 08-21-01



**HAYES ENGINEERING, INC.**  
 TRAVIS R. PRITCHETT, P.E.  
 2122 Adams St., Burleson, TX 76024-3601  
 TEL: (800) 795-2010 • FAX: (800) 795-2088

**PRITCHETT W.S.G.**  
 WATER SYSTEM IMPROVEMENTS  
 BURLESON ROAD - 6" WATER MAIN

**CONSTRUCTION NOTES**  
 LOCATION MAP

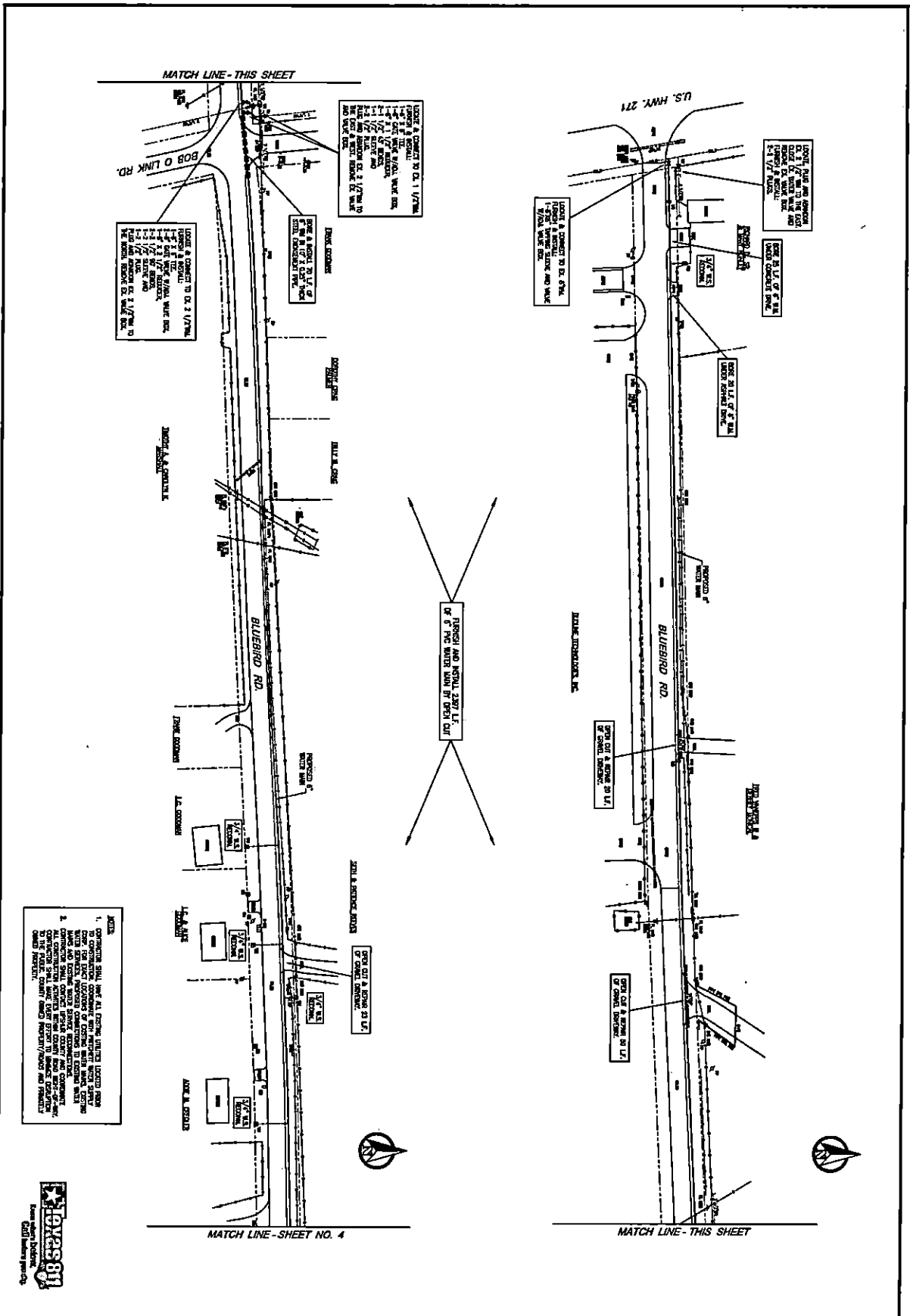

- NOTES**
1. CONTRACTOR SHALL VERIFY ALL EXISTING UTILITIES LOCATED FROM TO CORRELATION CORNER WITH ADJACENT PROPERTY OWNER. CONTRACTOR SHALL VERIFY LOCATION OF EXISTING WATER MAINS, GAS MAINS AND EXISTING WATER SERVICE CONNECTIONS. CONTRACTOR SHALL VERIFY LOCATION OF EXISTING WATER MAINS AND GAS MAINS. CONTRACTOR SHALL VERIFY LOCATION OF EXISTING WATER MAINS AND GAS MAINS. CONTRACTOR SHALL VERIFY LOCATION OF EXISTING WATER MAINS AND GAS MAINS.
  2. ALL CONSTRUCTION ACTIVITIES SHALL BE IN ACCORDANCE WITH THE CITY OF DALLAS STANDARD SPECIFICATIONS FOR WATER MAINS AND GAS MAINS.



DATE: 11/11/11  
 DRAWN BY: J.A.L.  
 CHECKED BY: J.A.L.  
 PROJECT: 3



**HAYES ENGINEERING, INC.**  
 TEXAS REGISTERED ENGINEERING FIRM # 14849  
 2128 Alpha St., Longview, TX 75601-5601  
 Tel: (803) 758-2010 • Fax: (803) 758-2008

**PRITCHETT W.S.C.**  
 WATER SYSTEM IMPROVEMENTS  
 BLUEBIRD ROAD - 6" WATER MAIN

**PROPOSED 6" WATER MAIN - PLAN 1**



MATCH LINE - THIS SHEET

MATCH LINE - SHEET NO. 3

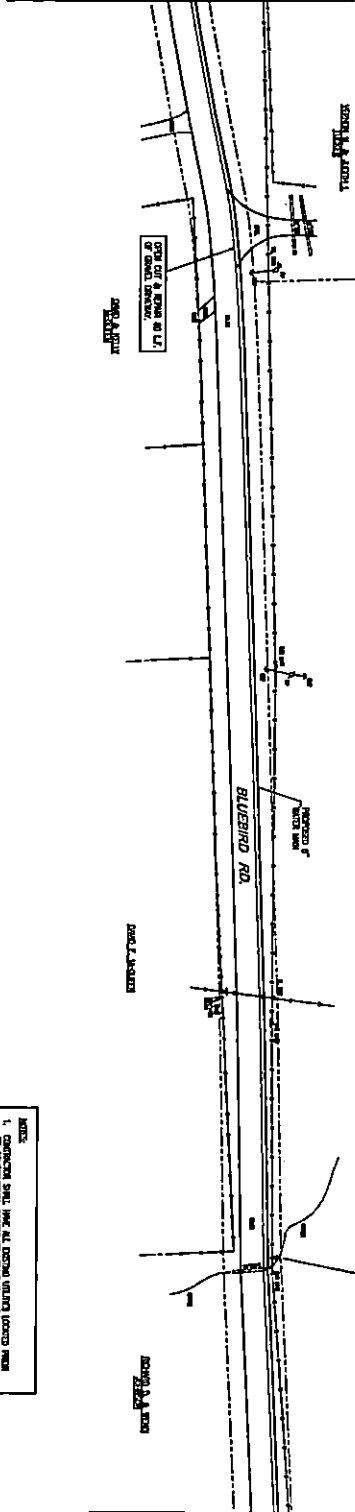

UPROCK AND REINSTALL 2500 LF OF 6" PVC WATER MAIN BY OPEN CUT

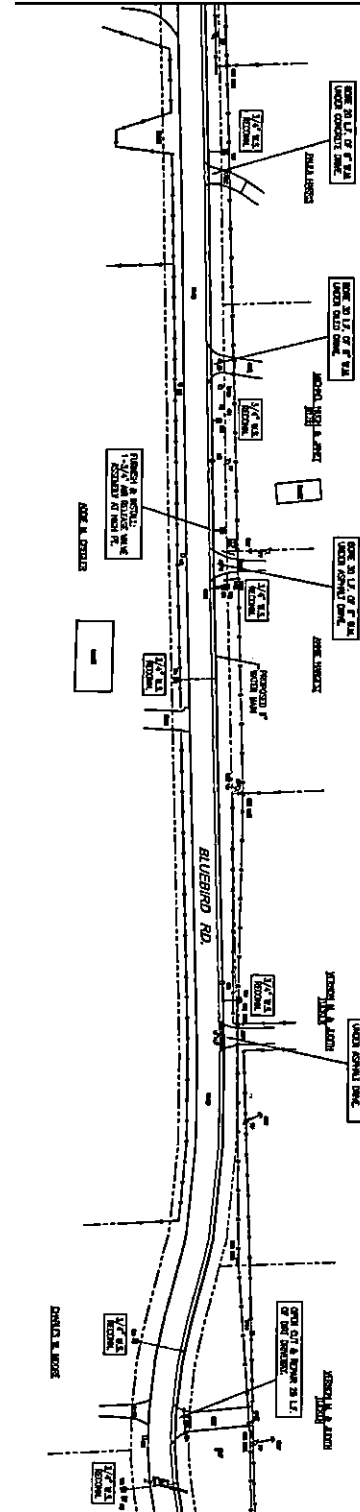

- NOTES:**
1. CONSTRUCTION SHALL BE AT THE DISCRETION OF THE ENGINEER. ALL MATERIALS AND METHODS SHALL BE APPROVED BY THE ENGINEER. THE CONTRACTOR SHALL BE RESPONSIBLE FOR OBTAINING ALL NECESSARY PERMITS AND APPROVALS FROM THE LOCAL AUTHORITIES. ALL CONSTRUCTION SHALL BE IN ACCORDANCE WITH THE LATEST EDITIONS OF THE TEXAS CONSTRUCTION CODES AND THE TEXAS ELECTRICAL CODE. ALL CONSTRUCTION SHALL BE IN ACCORDANCE WITH THE LATEST EDITIONS OF THE TEXAS CONSTRUCTION CODES AND THE TEXAS ELECTRICAL CODE. ALL CONSTRUCTION SHALL BE IN ACCORDANCE WITH THE LATEST EDITIONS OF THE TEXAS CONSTRUCTION CODES AND THE TEXAS ELECTRICAL CODE.
  2. ALL CONSTRUCTION SHALL BE IN ACCORDANCE WITH THE LATEST EDITIONS OF THE TEXAS CONSTRUCTION CODES AND THE TEXAS ELECTRICAL CODE. ALL CONSTRUCTION SHALL BE IN ACCORDANCE WITH THE LATEST EDITIONS OF THE TEXAS CONSTRUCTION CODES AND THE TEXAS ELECTRICAL CODE. ALL CONSTRUCTION SHALL BE IN ACCORDANCE WITH THE LATEST EDITIONS OF THE TEXAS CONSTRUCTION CODES AND THE TEXAS ELECTRICAL CODE.
  3. ALL CONSTRUCTION SHALL BE IN ACCORDANCE WITH THE LATEST EDITIONS OF THE TEXAS CONSTRUCTION CODES AND THE TEXAS ELECTRICAL CODE. ALL CONSTRUCTION SHALL BE IN ACCORDANCE WITH THE LATEST EDITIONS OF THE TEXAS CONSTRUCTION CODES AND THE TEXAS ELECTRICAL CODE. ALL CONSTRUCTION SHALL BE IN ACCORDANCE WITH THE LATEST EDITIONS OF THE TEXAS CONSTRUCTION CODES AND THE TEXAS ELECTRICAL CODE.



DATE: 11/11/11  
 DRAWN BY: J.L.L.  
 CHECKED BY: J.L.L.  
 APPROVED BY: J.L.L.  
 PROJECT NO.: 11-11-11

**HAYES ENGINEERING, INC.**  
 TEXAS REGISTERED ENGINEERING FIRM # 445  
 2126 Alpha St. Longview, TX 75801-3401  
 Tel: (903) 758-2010 • Fax: (903) 758-2000

**PRITCHETT W.S.C.**  
 WATER SYSTEM IMPROVEMENTS  
 BLUEBIRD ROAD - 6" WATER MAIN

PROPOSED 6" WATER MAIN - PLAN 2

MATCH LINE - THIS SHEET

MATCH LINE - SHEET NO. 4

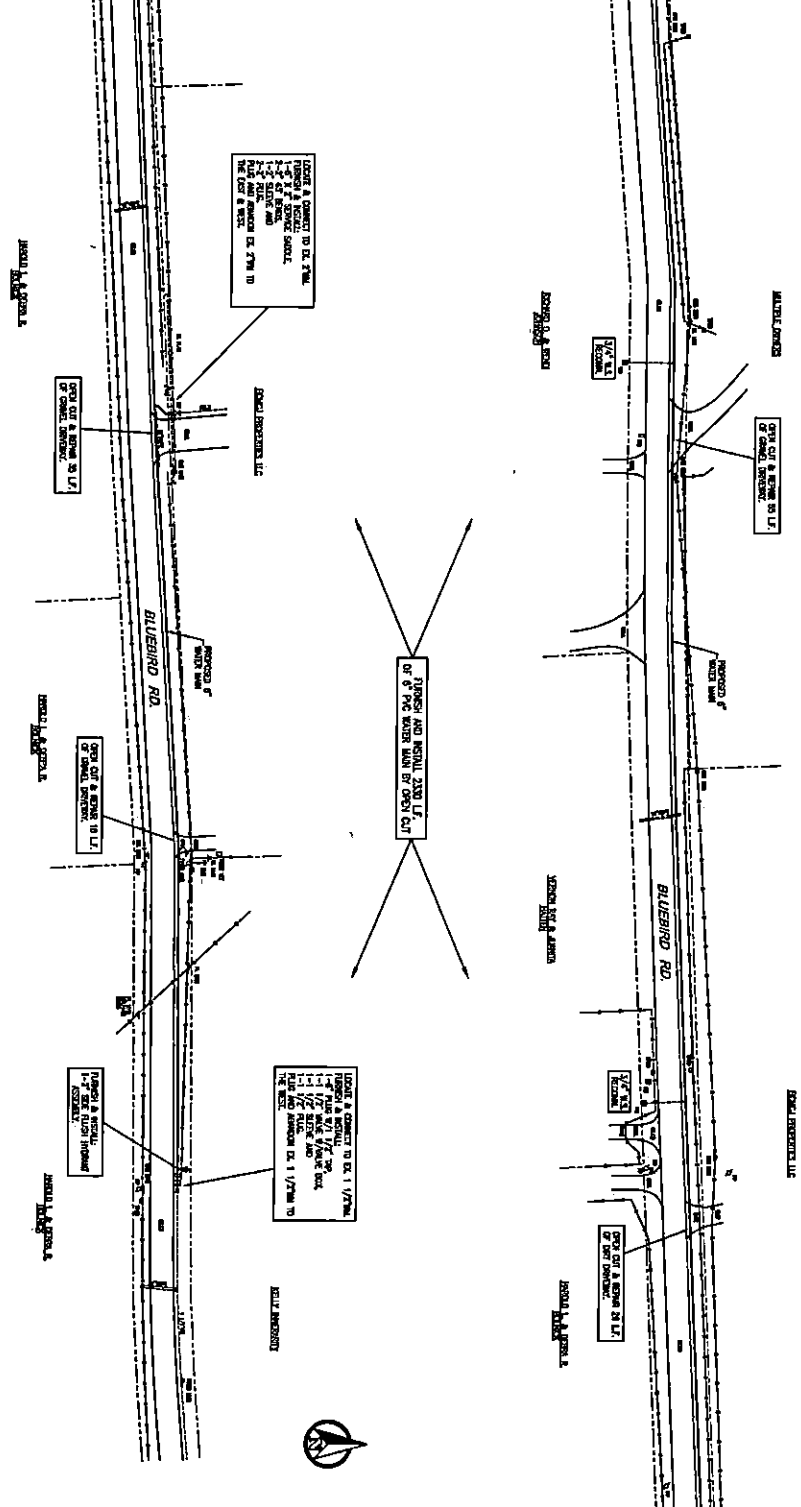

- NOTES**
1. CONTRACTOR SHALL VERIFY ALL EXISTING UTILITIES LOCATED FROM PLANS AND FIELD SURVEY. THE EXISTING LOCATION OF EXISTING UTILITIES SHALL BE VERIFIED BY EXCAVATION AND RECORDING. THE CONTRACTOR SHALL BE RESPONSIBLE FOR OBTAINING ALL NECESSARY PERMITS AND COORDINATING WITH ALL AFFECTED AGENCIES. THE CONTRACTOR SHALL BE RESPONSIBLE FOR OBTAINING ALL NECESSARY PERMITS AND COORDINATING WITH ALL AFFECTED AGENCIES. THE CONTRACTOR SHALL BE RESPONSIBLE FOR OBTAINING ALL NECESSARY PERMITS AND COORDINATING WITH ALL AFFECTED AGENCIES.
  2. ALL EXISTING UTILITIES SHALL BE PROTECTED AND MAINTAINED THROUGHOUT THE PROJECT. THE CONTRACTOR SHALL BE RESPONSIBLE FOR OBTAINING ALL NECESSARY PERMITS AND COORDINATING WITH ALL AFFECTED AGENCIES. THE CONTRACTOR SHALL BE RESPONSIBLE FOR OBTAINING ALL NECESSARY PERMITS AND COORDINATING WITH ALL AFFECTED AGENCIES.



DATE: 7/15/11  
 SHEET NO. 5  
 OF 7



**HAYES ENGINEERING, INC.**  
 TEXAS REGISTERED ENGINEERING FIRM # 1488  
 2128 Alpha St., Longview, TX 75601-5401  
 Tel: (903) 762-2010 • Fax: (903) 762-2099

**PRITCHETT W.S.C.**  
 WATER SYSTEM IMPROVEMENTS  
 BLUEBIRD ROAD - 6" WATER MAIN

**PROPOSED 6" WATER MAIN - PLAN 3**

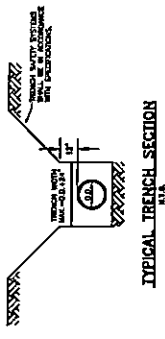

TYPICAL TRENCH SECTION  
N.E.A.

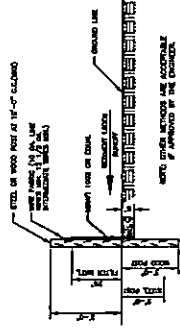

TYPICAL TEMPORARY SILT FENCE DETAIL  
N.E.A.

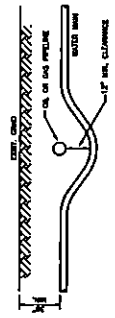

TYPICAL PIPELINE CROSSING  
N.E.A.

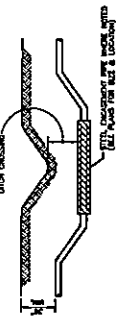

TYPICAL CREEK CROSSING  
N.E.A.

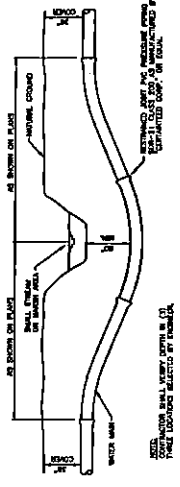

DIRECTIONAL BORING DETAIL  
N.E.A.

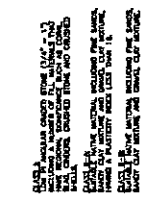

PRESSURE  
PVC PIPE EMBEDMENT  
(WITH RW)  
N.E.A.

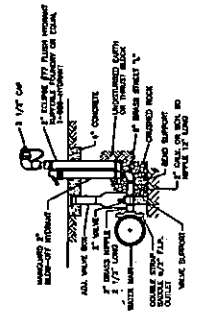

SIDE 2\"/>

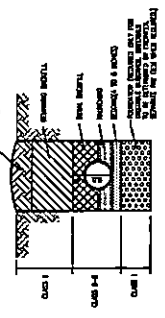

OPEN-CUT REPAIR DETAIL  
CONCRETE TRENCH  
N.E.A.

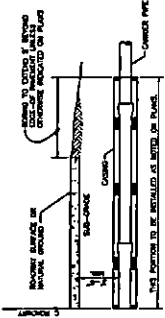

TYPICAL UTILITY ENCASUREMENT HALF-SECTION  
FOR COUNTY ROADS  
N.E.A.

TYPICAL ENCASUREMENT DETAILS

CONCRETE PIPE DIA.	CONCRETE PIPE WALL THICKNESS
6"	1 1/2"
8"	1 3/4"
10"	2"
12"	2 1/4"
14"	2 3/4"
16"	3"
18"	3 1/4"
20"	3 3/4"
24"	4 1/4"
30"	5 1/4"
36"	6 1/4"
42"	7 1/4"
48"	8 1/4"
54"	9 1/4"
60"	10 1/4"

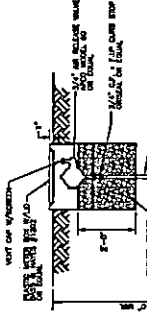

3/4\"/>

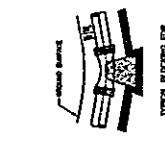

TYPICAL BLOCKING DETAIL  
CONCRETE BLOCKING  
N.E.A.

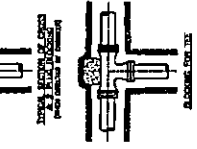

TYPICAL BLOCKING DETAIL  
CONCRETE BLOCKING  
N.E.A.

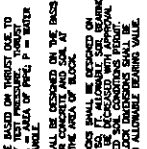
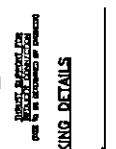

TYPICAL BLOCKING DETAIL  
CONCRETE BLOCKING  
N.E.A.

THRUST BLOCKING DETAILS

1. ALL BLOCKING SHALL BE CONCRETE UNLESS OTHERWISE SHOWN. THE CONCRETE SHALL BE 2800 PSI COMPRESSIVE STRENGTH.
2. THE THRUST BLOCKING SHALL BE 12 INCHES WIDE AND 12 INCHES HIGH. THE THRUST BLOCKING SHALL BE 12 INCHES WIDE AND 12 INCHES HIGH.
3. THE THRUST BLOCKING SHALL BE 12 INCHES WIDE AND 12 INCHES HIGH. THE THRUST BLOCKING SHALL BE 12 INCHES WIDE AND 12 INCHES HIGH.
4. THE THRUST BLOCKING SHALL BE 12 INCHES WIDE AND 12 INCHES HIGH. THE THRUST BLOCKING SHALL BE 12 INCHES WIDE AND 12 INCHES HIGH.
5. THE THRUST BLOCKING SHALL BE 12 INCHES WIDE AND 12 INCHES HIGH. THE THRUST BLOCKING SHALL BE 12 INCHES WIDE AND 12 INCHES HIGH.
6. THE THRUST BLOCKING SHALL BE 12 INCHES WIDE AND 12 INCHES HIGH. THE THRUST BLOCKING SHALL BE 12 INCHES WIDE AND 12 INCHES HIGH.
7. ADDITIONAL REINFORCEMENT MAY BE REQUIRED FOR HORIZONTAL BLOCKING TO HANDLE UNUSUAL BEAM LOADING CONDITIONS.
8. ALL BLOCKING SHALL HAVE A MINIMUM SIDE COVER OF 1 FT.
9. ALL BLOCKING SHALL BE CONCRETE UNLESS OTHERWISE SHOWN.
10. ALL BLOCKING SHALL BE CONCRETE UNLESS OTHERWISE SHOWN.
11. ALL BLOCKING SHALL BE CONCRETE UNLESS OTHERWISE SHOWN.
12. ALL BLOCKING SHALL BE CONCRETE UNLESS OTHERWISE SHOWN.
13. ALL BLOCKING SHALL BE CONCRETE UNLESS OTHERWISE SHOWN.
14. ALL BLOCKING SHALL BE CONCRETE UNLESS OTHERWISE SHOWN.
15. ALL BLOCKING SHALL BE CONCRETE UNLESS OTHERWISE SHOWN.
16. ALL BLOCKING SHALL BE CONCRETE UNLESS OTHERWISE SHOWN.
17. ALL BLOCKING SHALL BE CONCRETE UNLESS OTHERWISE SHOWN.
18. ALL BLOCKING SHALL BE CONCRETE UNLESS OTHERWISE SHOWN.
19. ALL BLOCKING SHALL BE CONCRETE UNLESS OTHERWISE SHOWN.
20. ALL BLOCKING SHALL BE CONCRETE UNLESS OTHERWISE SHOWN.

